

The background features a complex, organic pattern of marbled colors, transitioning from deep magenta on the left to bright cyan on the right. A thick, white, hand-drawn style line starts as a curve on the left and extends diagonally across the upper right portion of the image. The text is overlaid on this background.

IIDA

no

DESIGN AWARDS

2022 WINNER LOOKBOOK



★ WINNER: BUILDING REPOSITIONING/BUILDING AMENITIES
HARVARD UNIVERSITY SOLDIERS FIELD PARK

Elkus Manfredi Architects (MA)

RDK Engineers / LAM Partners / Acentech / Kalin Associates / Vanderweil Engineers / Jensen Hughes /
McNamara Salvia / IBI Placemaking / Robbie McCabe Consulting / KMA, LLC

IIDA
ne
DESIGN AWARDS



★ WINNER: COMMUNITY AND CULTURE
WORCESTER PUBLIC LIBRARY CHILDREN'S ROOM

LLB Architects (RI)

Sladen Feinstein / Forbo / Wright Architectural Millwork / Keilhauer / KI /
Hale Manufacturing, Inc. / Leland / Arcadia / Stinson

IIDA
ne
DESIGN AWARDS



★ WINNER: EDUCATION SMALL
COUNTWAY LIBRARY RENOVATION
Shepley Bulfinch (MA)

Odeh Engineers / Sladen Feinstein / Acentech / ColburnGuyette Foodservice Design Consulting / Lee Kennedy / MillerKnoll / BR+A / Thornton Tomasetti / Barlow Architectural Millwork / Arktura



★ WINNER: HEALTH & WELLNESS
GLICKMAN LAUDER CENTER OF EXCELLENCE IN AUTISM AND
DEVELOPMENTAL DISORDERS

E4H Environments for Health Architecture (Portland, ME)

Acentech / Langford & Low / Stantec / Foley Buhl Roberts & Associates Inc. / Barry J. Hosmer

IIDA
ne
DESIGN AWARDS



★ WINNER: HOSPITALITY HOTEL/LODGING
THE CLOUDVEIL

TruexCullins Architecture & Interior Design (VT)

CLB Architects / IBI Group / Yarrow Group / Helius Lighting Group /
Bray Whaler / Dick Anderson Construction / Nelson Engineering /
Matsuo Engineering, LLC / Mecho, Inc. and JTEC, Inc. / KL&A, Inc.



★ WINNER: HOSPITALITY RESTAURANT
OMNI MOUNT WASHINGTON
TruexCullins Architecture & Interior Design (VT)
Bull Stockwell Allen / Sue Dulmage Associates

IIDA
ne
DESIGN AWARDS



★ WINNER: RESIDENTIAL MULTI-UNIT
144 ADDISON STREET
Arrowstreet (MA)

Available Light / Peabody Office / Kalin Associates /
Redgate Real Estate Advisors / Simpson Gumpertz & Heger



★ WINNER: RESIDENTIAL PRIVATE
SUNSET HILL

Hutker Architects (MA)

Martha's Vineyard Construction Co. / Horiuchi Solien /
Siegel Associates / TE2 Engineering LLC



★ WINNER: STUDENT HOUSING
EASTERN CONNECTICUT STATE UNIVERSITY - SHAFER HALL RENOVATIONS
Stantec (Boston, MA)

Odeh Engineers / BVH Integrated Services, Inc. / LAM Partners / ARUP / Acentech / Colburn&Guyette /
Kalin Associates / Insalco Corporation / Richter & Cegan / Barbizon Light of New England /
Wiss Janney Elstner Associates, Inc. / Whitney Veigas / O&G Industries Inc.



★ WINNER: SCIENCE & RESEARCH SMALL
DEWPOINT THERAPEUTICS AT 451 D STREET

Lab / Life. Science. Architecture, Inc. (MA)

Wise Construction / TotalOffice Interiors / Boston Light Source /
Interface / Vanderweil Engineers / Total Glazing / FalkBuilt /
Donovan Consultants



★ WINNER: SCIENCE & RESEARCH LARGE

THE CHILDREN'S NATIONAL RESEARCH & INNOVATION CAMPUS

Elkus Manfredi Architects (MA)

Bard, Rao + Athanas Consulting Engineers / Acentech / Array Architects, Inc. / Castelli Design /
Jensen Hughes / Roll Barresi & Associates / EHT Traceries / McNamara Salvia / The Green Engineer /
Mikyoung Kim Design

IIDA
ne
DESIGN AWARDS

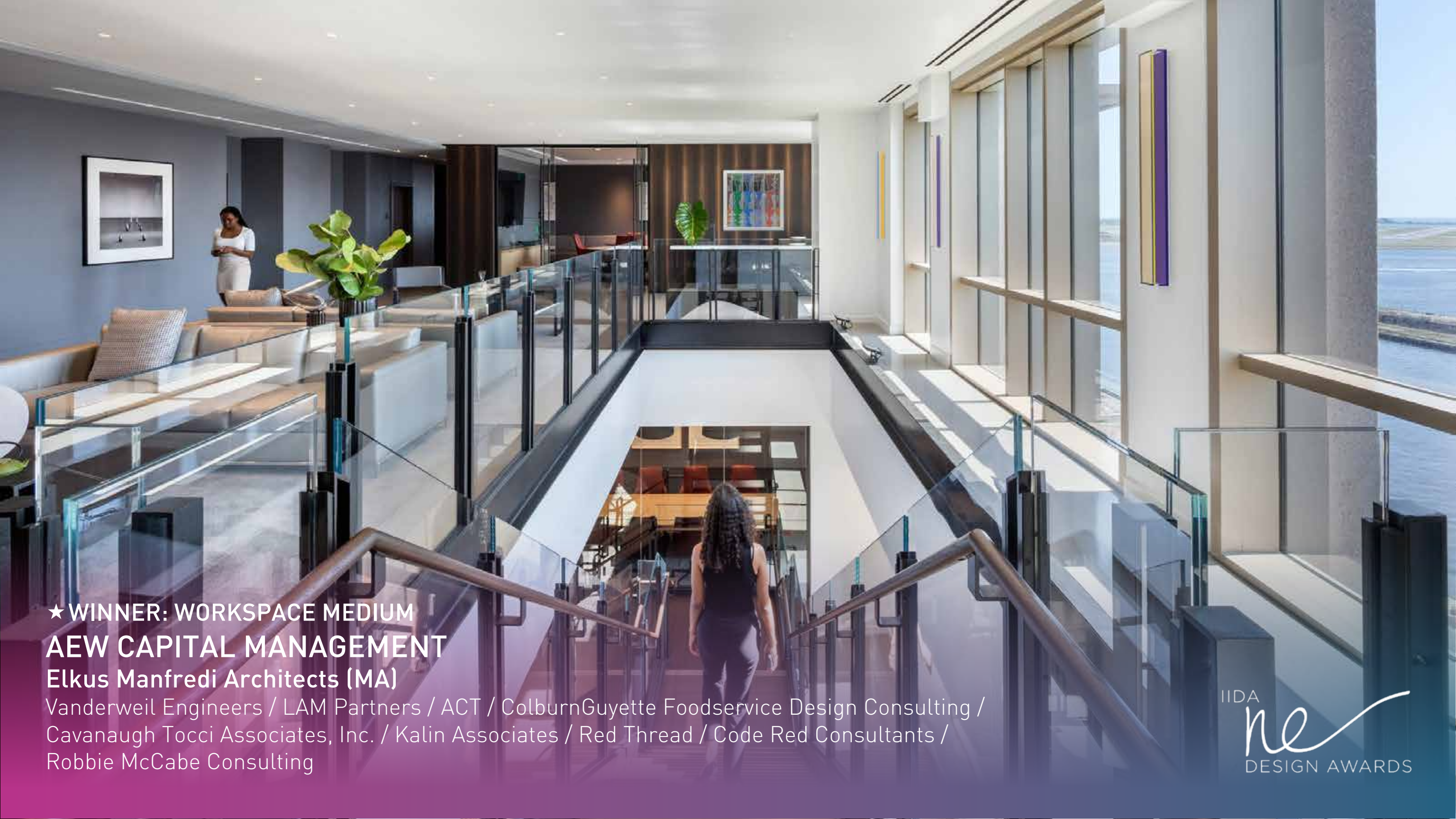

★ WINNER: WORKSPACE MEDIUM
AEW CAPITAL MANAGEMENT
Elkus Manfredi Architects (MA)

Vanderweil Engineers / LAM Partners / ACT / ColburnGuyette Foodservice Design Consulting /
Cavanaugh Tocci Associates, Inc. / Kalin Associates / Red Thread / Code Red Consultants /
Robbie McCabe Consulting



★ WINNER: WORKSPACE LARGE
VERIZON AT THE HUB
Gensler (MA)

Crabtree McGrath Associates / LeMessurier / John Moriarty & Associates /
Stantec / Lighting Workshop / Intertek / Design Communications, Ltd.



★ WINNER: WORKSPACE SMALL

★ WINNER: HUMANITY OF DESIGN

TEN PERCENT HAPPIER HEADQUARTERS

Merge Architects, Inc. (MA)

Stone Source / WSP / Trinity Construction / Evan Hankin



★ WINNER: HOSPITALITY RETAIL & EXPERIENTIAL

★ WINNER: BEST IN SHOW

HIGH STREET PLACE

Genster (MA)

Acentech / AKF Group LLC / Consentini Associates, Inc. / LAM Partners / Le Messurier /
Gilbane Building Company / Beals Associates, Inc. / Feldman Land Surveyors /
Groundswell Design Group, Inc. / Wiss, Janney, Elstner Associates, Inc. / Younts Design, Inc.



IIDA

no

DESIGN AWARDS

15TH ANNUAL CELEBRATION